

Endeavor Building – Shamrock Quay

Lower William Street, Northam, Southampton, SO14 5QL



- Waterside office space
- Existing fit out available
- Flexible lease terms
- Comfort cooling
- Allocated parking spaces

Availability From

2,700 sq. ft to 8,082 sq. ft

250.84 sq. m to 750.84 sq. m

Endeavor Building

To Let

Description

The Endeavour Building is the principal office space at Shamrock Quay, offering high quality office content and boasting views of the marina & river. The complex houses a variety of tenants, including restaurant operators and retail facilities.

Location

The office building is situated at Shamrock Quay, Southampton, offering excellent connectivity and amenities for businesses. The location is easily accessible via major roads, including the M27 (approx. 4 miles away) and A33 (approx 2 miles away), providing direct routes to Southampton city centre and the wider region. Southampton Central train station is approximately 1.5 miles away. Nearby amenities include a variety of shops, cafes, and restaurants within the marina itself, as well as additional options in the city centre. The area is also home to several specialist marine trades, making it ideal for businesses in related industries.

Terms

A new Full Repairing and Insuring lease upon terms to be agreed at a rent of £10 per sq. ft. exclusive of all other outgoings

Service Charge

A building service charge and estate service charge are payable. Further details on request.

Rateable Value

The rateable value will need to be re-assessed.

EPC

Units 9-11 B-43

Units 19-24 B-38

VAT

All prices, premiums and rents, etc. are quoted exclusive of VAT at the prevailing rate

Emma Lockey
Director
emma.lockey@cbre.com
M +44 (0) 7825 357481

Joss Gray
Surveyor
joss.gray@cbre.com
M +44 (0) 7392 285000

Lauren Udall
Director
Lauren.udall@realest.uk.com
M +44 (0) 7799 623239

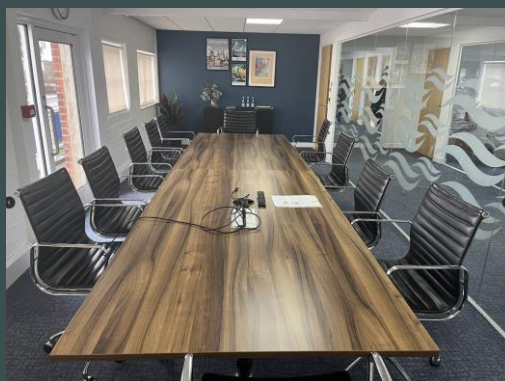

© 2021 CBRE, Inc. All rights reserved. This information has been obtained from sources believed reliable, but has not been verified for accuracy or completeness. You should conduct a careful, independent investigation of the property and verify all information. Any reliance on this information is solely at your own risk. CBRE and the CBRE logo are service marks of CBRE, Inc. All other marks displayed on this document are the property of their respective owners, and the use of such logos does not imply any affiliation with or endorsement of CBRE. Photos herein are the property of their respective owners. Use of these images without the express written consent of the owner is prohibited.

Endeavour Building - Floor Plans

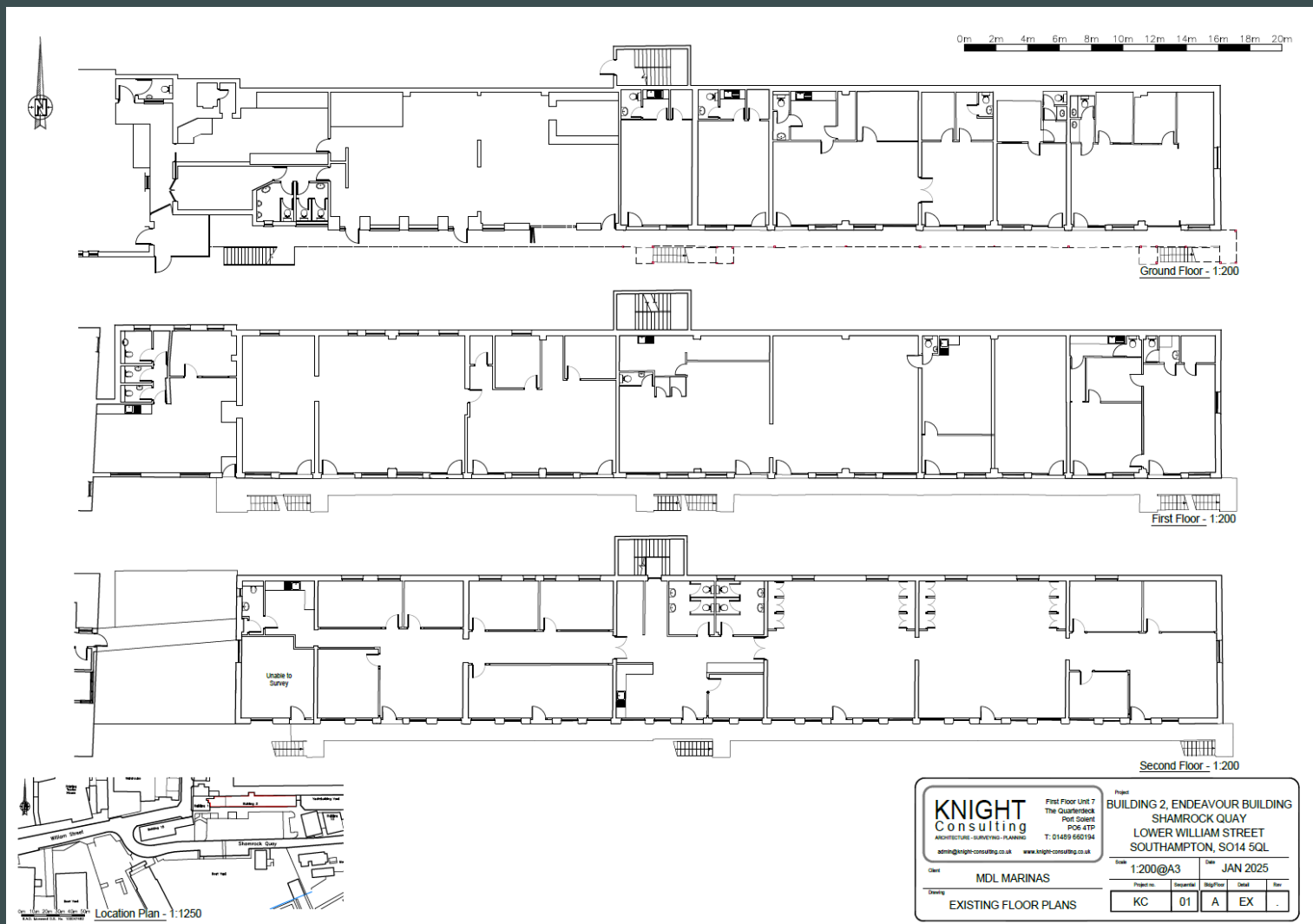

Availability

Units 9a, 9b, 10, 11	2,700 sq. ft.	250.84 sq. m
Units 19-24	5,382 sq. ft.	500.00 sq. m